

Carbon Dioxide Transfer Pumps

Our Carbon Dioxide Transfer Pumps are available for transferring low pressure liquid CO₂ from one approved storage vessel to another. These units are shipped as a complete assembly which is suitable for outdoor use.

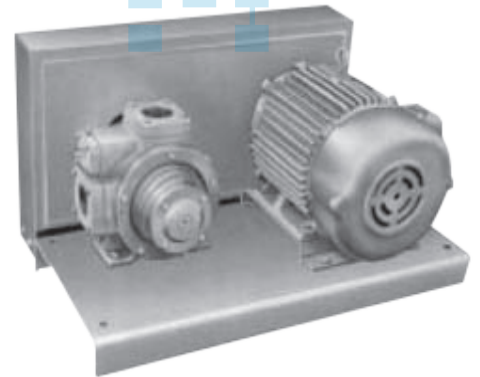

FEATURES

- Positive displacement vane pump with 400 psig MAWP
- Electric motor and controls suitable for outdoor service
- Direct drive mounting with gear reducer
- Capacities are based on a maximum differential pressure of 50 psig
- Differential pressure by-pass valve
- Inlet Y-Strainer
- 1/2" purge ball valve and safety relief valve

Electrical Characteristics

- 240/460 Volts, 60 Cycle, 3 Phase (other electrical characteristics available upon request.)

Model	Nominal Capacity	HP	DIMENSIONS (l x w x h)	WEIGHT*
SPA-35	35 gal/min	3	44" x 20" x 34"	450 lbs.
	132 ltr/min	3	112 cm x 51 cm x 86cm	204 kg
SPA-55	55 gal/min	5	44" x 20" x 34"	505 lbs.
	208 ltr/min	5	112 cm x 51 cm x 86cm	229 kg
SPA-150	150 gal/min	7.5	50" x 20" x 34"	575 lbs.
	568 ltr/min	7.5	127 cm x 51 cm x 86 cm	261 kg
SPA-300	300 gal/min	15	58" x 25" x 36"	745 lbs.
	1136 ltr/min	15	147 cm x 64 cm x 91 cm	338 kg

*Published weights include equipment only. Shipping crate(s) are not included.

NOTE:

- Piping options for bi-directional flow available on request
- Other voltages available upon request (may have an impact on capacities)

Circulation Pumps

FEATURES

- Circulating rate of 8 gal./min. (30.3 L/min)
- 2 SQHH liquid CO₂ Pumps
- Switching Valves
- Safety relief valves
- Pump selector switch
- Enclosed in rainproofed housing

General Specifications

- 1" (2.54 cm) M.P.T. Inlet and Outlet Connections 3 HP, 3,600 rpm motors
- Dimensions: (L x W x H): 44"x 38" x 27" (111.8 cm x 96.5 cm x 68.6 cm)
- Weight: 200 lbs. (90.72 kg)

Electrical Characteristics

- 220V or 460V, 60 Hz., 3 Phase

